

Product Catalogue

Leading the way in stonewool insulation

■ Revolutionizing thermal insulation for a sustainable future. Discover excellence in energy efficiency with us.



We serve clients worldwide with a global product range that fits their local needs



Hi-Tec Rock Fibre Pvt. Ltd-

Excellence in seamless blending expertise and precision to manufacture superior Stonewool thermal insulation products.

Since our inception in 2011, we have led the industry, manufacturing Lightly Resin Bonded Mattress (LRB) and Resin Bonded Slabs (RB) under the esteemed brand "EnSave." Our robust production capacity of 21,000 metric tons per annum, housed in a sprawling 20-acre plant spanning 90,000 sq ft, equipped with the latest technology, ensures consistent product quality.

ISO certified: We adhere to industry standards such as IS, ASTM, and BS.

Situated centrally, our strategic location not only enables efficient nationwide material delivery but also ensures timely deliveries and cost efficiency. Leveraging our central position, we prioritize swift transportation, providing clients with reliable and on time service while maintaining competitive and efficient costs. Backed by a seasoned and skilled team, our commitment to process control compliance is evident in our fully equipped laboratory, guaranteeing that EnSave Stonewool Products meets both domestic and international benchmarks. As we cater to diverse industries, including power plants, refineries, steel plants, and real estate development, we invite you to join us in building lasting business associations based on our impressive customer satisfaction, wide variety of products across categories and sustainable products in thermal, acoustic, and fire control.

**At Hi-Tec
we are**



At Hi-Tec, we are pioneers of innovation, dedicated to redefining industry standards. With unwavering commitment, we strive to deliver cutting-edge, sustainable and efficient products that transcend expectations, shaping a future of excellence.



Unleashing Natural Power of Stone.



Thermal properties

Our stonewool exhibits exceptional insulation properties, ensuring effective temperature regulation indoors by minimizing heat transfer. This reduces the reliance on excessive heating or cooling systems for maintaining comfortable environments.



Acoustic capabilities

With its dense and fibrous composition, stonewool efficiently absorbs sound waves, making it an ideal solution for mitigating noise transmission between spaces or from external sources.



Fire - resilience

Stonewool possesses inherent non-combustibility, allowing it to withstand high temperatures without compromising its integrity or emitting harmful fumes. This characteristic makes it a preferred choice for applications prioritizing fire safety, such as in building construction.



Water Repellency

EnSave Stone wool can be engineered with special additives & binders to repel direct water. It saves valuable assets from getting damaged of heavy rain pour.



Compatibility

Available in various forms like batts, boards, blankets, and loose-fill insulation, stonewool offers flexibility in installation across diverse settings, including walls, floors, roofs, and HVAC systems.



Long Lasting

Stonewool is a robust material that maintains its structural integrity over prolonged periods. It resists compression, settling, and deterioration, ensuring sustained performance and reducing the need for frequent maintenance.



Recyclability

Manufactured from natural and abundant resources such as basalt rock and recycled products available, stonewool aligns with sustainability principles. Furthermore, its recyclability at the end of its lifecycle promotes a circular economy and diminishes environmental impact.

EnSave Stone Wool Resin Bonded Slab

EnSave Stone Wool Resin Bonded Slabs (RB Slabs) are designed for Thermo - Acoustic Insulation. RB Slabs/Boards are most suited for interior applications where thermal regulation, acoustic control and fire safety is required. RB Slabs/Boards are available in wide range of density, lighter to heavier as per the application requirements, can be customised with unfaced and one/both side layer of foil scrim Kraft (FSK), BGT, ALG.

EnSave StoneWool Resin Slabs/Boards are strong, resilient, easy to cut to intricate shapes & handle. Ideal to be used on flat and slight curved surfaces. Slabs are widely used for acoustic control & fire safety. Our products are free from CFC, HFC, HCFC & ASBESTOS. Compatible with all building materials our slabs have excellent load bearing characteristics due to stable fibre layering and even thickness, It improves air conditioning performance and reduces electricity bill. A well-insulated space creates comfortable living zone with regulated temperature, acoustic control, and fire safety.

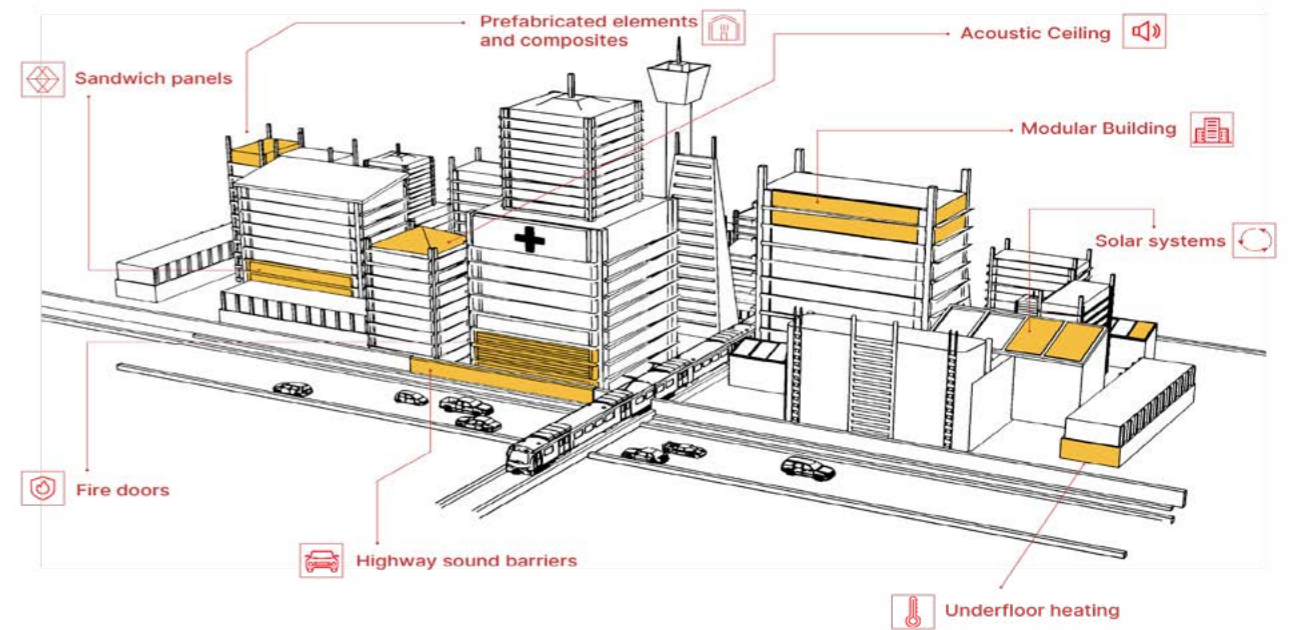

COMMERCIAL & RESIDENTIAL BUILDINGS, AIRPORTS, METRO & RAILWAY STATIONS, MALLS, AUDITORIUMS, THEATRES, HVAC DUCTS, NOISE BARRIERS, GENSETS, PANELS, COLD STORAGES, CHIMNEYS, EQUIPMENTS, TANKS, COLUMNS, OVENS ETC.

RB Slab - 48 Kg/M³

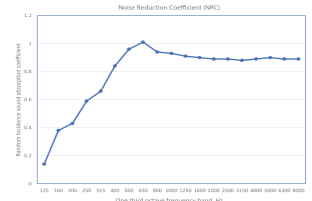
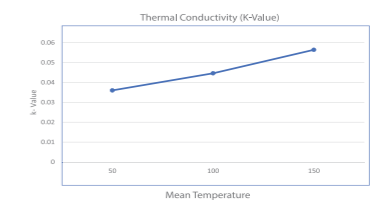

RB Slab - 96 Kg/M³

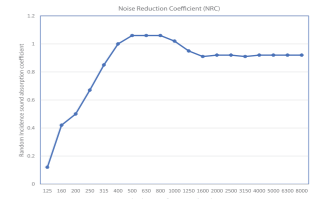
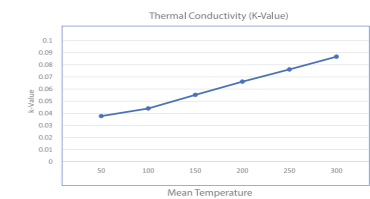

Product Specifications

Product Spec : IS: 8183, ASTM C-612, BS:3958 PART-5

Service Temp : - 50°C to 750°C

Size : 1000 mm X 500 mm

Thickness : 25mm to 100mm

Density : 48 kg/M³ to 200 kg/M³

Packing : HDPE Bags OR Shrink Wrapped

Facing : FSK, BGT, ALG & UNFACED

Application Field : Thermal & Acoustic Insulation & Fire Safety in Commercial & Residential Buildings, HVAC Ducts, and Industrial Equipment



Rigid / Semi-Rigid



Easy to Handle



Dimensionally Stable



Strong



Easy to cut

Technical Parameters

Property	Value							Specification
	Temperature	50	100	150	200	250	300	
Thermal Conductivity(W/mk)	48 Kg/ M ³	0.0360	0.0446	0.0564	-	-	-	IS:3346
	64 Kg/ M ³	0.0352	0.0448	0.0546	-	-	-	
	100 Kg/ M ³	0.0377	0.0440	0.0552	0.0661	0.0762	0.0867	
	120 Kg/ M ³	0.0362	0.0465	0.0558	0.0678	0.0776	0.0583	
	144 Kg/ M ³	0.0357	0.0371	0.0476	0.0618	0.0706	0.0817	
Fire Resistant	Class 0							BS: 476
Maximum Service Temperature	-50 °C to 750 °C							IS: 8183
Smoke Developed Index	0-25 (passes)							ASTM E-84
Flame Spread Index	0-25 (passes)							ASTM E-84
Noise Reduction coefficient	0.90							IS: 8225:87
Compressive Strength	8 kPa@10% Compression							ASTM C - 165

Improved efficiency

Hi-Tec's Stonewool insulation products redefine efficiency, offering optimal thermal regulation. By preventing heat transfer, our products create a stable indoor climate, reducing energy consumption and enhancing operational efficiency across various industries.

Energy conservation

At Hi-Tec, we champion energy conservation. Our stonewool insulation products act as a formidable barrier, minimizing heat loss or gain. This not only lowers energy bills but also aligns with sustainable practices, contributing to a greener tomorrow.

Environmental sustainability

Committed to environmental responsibility, Hi-Tec's insulation products harness the natural properties of stonewool. From production to application, our products promote sustainability, ensuring minimal ecological impact and a healthier planet for generations to come.

Enhanced comfort

Experience unparalleled comfort with Hi-Tec's stonewool insulation products. By regulating temperature and sound, our products create inviting and peaceful spaces. Enjoy a heightened sense of well-being and tranquility in environments insulated for superior comfort.

Safety

Safety is paramount in our stonewool insulation products. With stonewool's inherent fire-resistant properties, Hi-Tec products provide a protective shield. Trust in our commitment to safety, delivering peace of mind across industrial, commercial and residential applications.

Ensave Advantage

EnSave, our flagship brand, brings a distinctive edge. Manufactured with compliance to specifications, EnSave stonewool products from Hi-Tec guarantee unparalleled performance, setting new benchmarks in thermal insulation, acoustic control, and fire resistance. Choose EnSave for a superior insulation experience.

Advantages of our insulation products.

EnSave Stone Wool Light Resin Bonded Mattresses

EnSave Stone Wool Light Resin Bonded Mattresses or Rolls (LRB) are made from natural rocks & stones by melting into fibres and binding them with thermosetting binders to form the shape of mattresses or rolls. Manufacturing is performed under highly controlled parameters to ensure stable fibre distribution for even density and thickness. These mattresses are also added with speciality additives for water repellence and corrosion control.

EnSave Stonewool LRB Mattress/Rolls are flexible, backed with wiremesh for support these mattresses are most easy to use, it can be easily curved, wrapped on equipment's, pipes or irregular surfaces. LRB mattress are most suitable for wide range of operating temperature ranging for -50 to 750 degree cel. Insulation saves costly fuel & energy consumption, overall improving industrial efficiency & operations. Added with water repellent and corrosion control additives our products increase life cycle of an industrial complex. It also gives a safety layer for personnel protection working in high temperature areas by reducing surface temperature.

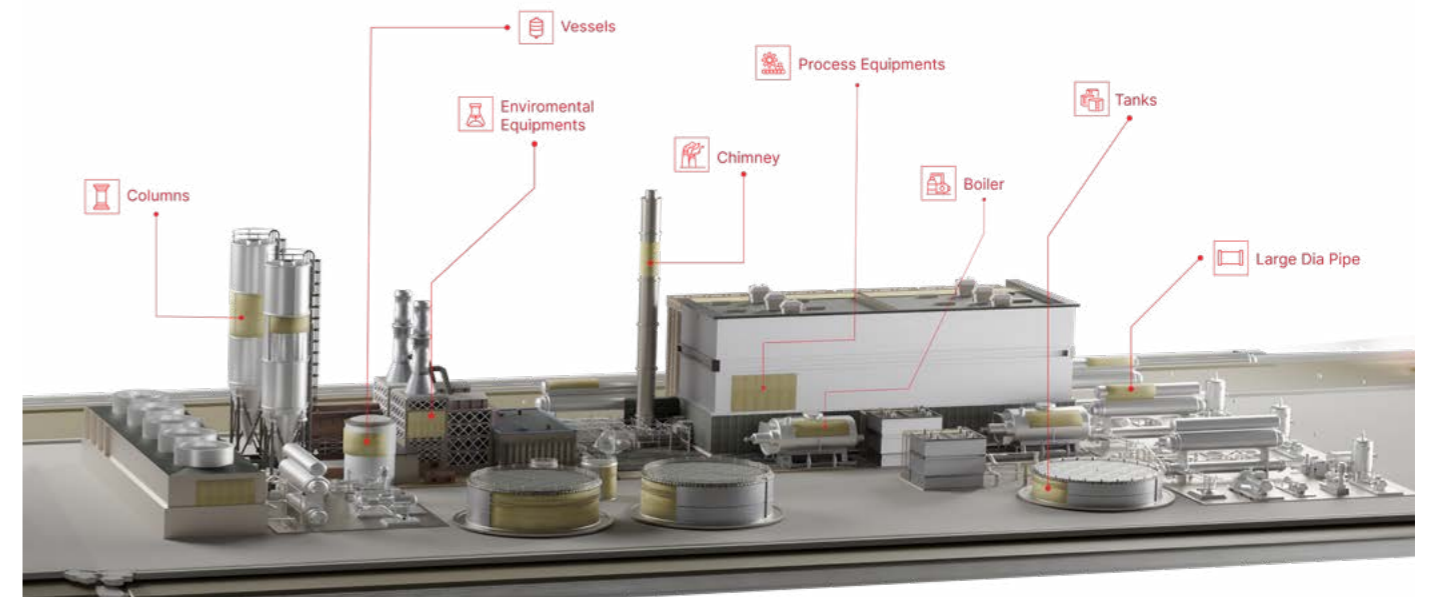

**POWER PLANTS,
REFINERIES, PROCESS
BOILERS, ESP's, DENOX
FGD, SCR, CEMENT,
PAPER, CHEMICAL
INDUSTRY, STEEL
MILL, FERTILIZER,
SUGAR MILLS**

LRB - 150 Kg/M³

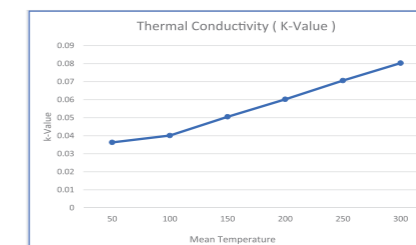

LRB - 100 Kg/M³

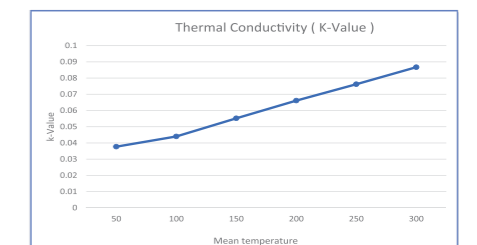

Product Specifications

Product Spec : IS: 8183, ASTM C-592, BS:3958 PART-3

Service Temp : - 50°C to 750°C

Size : 1640 X 1220 mm (Mattress form) & 4000 X 800 mm (Rolls Form)

Thickness : 25mm to 100mm

Density : 85 kg/M³ to 200 kg/M³

Packing : HDPE Bags

Facing : Galvanized Steel or Stainless-Steel Hexagonal Wire Mesh

Application Field : Boilers & Industrial Equipments, Ducts, Tanks, Vessels, Large Dia Pipes etc



High Density



Semi Flexible Mat



Fewer Joints and Less Wastage



Low Binder



Customized Length

Technical Parameters

Property	Value							Specification
	Temperature	50	100	150	200	250	300	
Thermal Conductivity (W/mK)	100 Kg/ M ³	0.0377	0.0440	0.0552	0.0661	0.0762	0.0867	IS:3346
	120 Kg/ M ³	0.0362	0.0465	0.0558	0.0678	0.0766	0.0583	
	128 Kg/ M ³	0.0360	0.0412	0.0473	0.0606	0.0739	0.0860	
	144 Kg/ M ³	0.0357	0.0371	0.0476	0.0618	0.0706	0.0817	
	150 Kg/ M ³	0.0363	0.0401	0.0505	0.0602	0.0706	0.0803	
	192 Kg/ M ³	0.0360	0.0401	0.0496	0.0553	0.0682	0.0694	
Service Temperature	-50 °C to 750 °C							IS: 8183
Shot Content	<5							IS: 8183
Moisture Content %	<2% Max							IS: 8183
Chloride Content	Max 0.001 < 10mg/Kg							IS: 8183 ASTM C 591 ASTM C 871
Sulphur Content	0.20% Max							IS: 3144
Compressive Strength	8 kPa@10% Compression							ASTM C-165



Power Generation

Our products excel across various power generation sources—coal, gas, and nuclear plants—optimizing efficiency, minimizing fuel consumption, and reducing the carbon footprint. With superior insulation, we enhance thermal regulation, ensuring streamlined operations and bolstering safety in power plants.



Industrial Facilities

Empowering diverse industries with innovative thermal insulation solutions for success.

In industrial facilities, Hi-Tec's stonewool insulation products stand as indispensable assets. From cement plants and refineries to steel plants and sugar, chemical and process industries, our products ensure superior thermal regulation, acoustic control, and fire resistance. Elevate operational efficiency, safety, and sustainability with Hi-Tec's cutting-edge insulation tailored for diverse industrial applications.



Construction Industry

In the construction industry, Hi-Tec's stonewool insulation products play a pivotal role. From enhancing energy efficiency in buildings to providing acoustic comfort, our products contribute to sustainable construction practices and lasting structural performance.



Oil and Gas Industry

Hi-Tec's stonewool insulation products are crucial in the Oil and Gas sector, particularly in refinery and chemical complexes. Our advanced thermal insulation guarantees precise temperature control, improving operational efficiency, and reinforcing safety in critical processes. Applied to meet stringent industry standards, our products ensure seamless operations.



Infrastructure

Hi-Tec's stonewool insulation products are highly compatible with building materials, offering superior thermal and acoustic insulation. Applied across various projects, including airports, metros, warehouses, and auditoriums, our products contribute to energy efficiency, safety, and optimal functionality in diverse applications within the infrastructure sector.

Our Valued Customer



Approvals & Credentials

EnSave Stone Wool Preformed Pipe Section

EnSave Pre-formed Pipe Sections are made from stone wool felt with higher binder content. Preformed Pipe Section has excellent water repellent and corrosion control properties. Uniform density and thickness ensure proper application, efficient operation and overall savings to the operating industry. Their excellent fit and high compression resistance means they can be applied in a single layer without any additional spacers. Being concentrically formed and precisely made to fit standard pipe diameters they offer complete 360 degree thermal resistance.

EnSave Stonewool Pipe Sections (SPI) are cylindrical in shaped and in split hinged for easy, snap-on application. These are easy to cut, fit, handle and has high levels of thermal efficiency and strength. It's combination of density, strength and excellent thermal conductivity at high temperatures offer efficient insulation & reduction of heat losses resulting in operating cost savings. Pipe Sections also provide personnel safety for workers operating in higher temperature areas.



REFINERY, POWER GENERATION, GAS LINES, PHARMA, CEMENT, PETROCHEMICAL & PROCESS PLANTS, EDIBLE OIL, DISTILLATION UNITS, REFRIGERATION UNITS, CHILLERS, HVAC SYSTEMS.

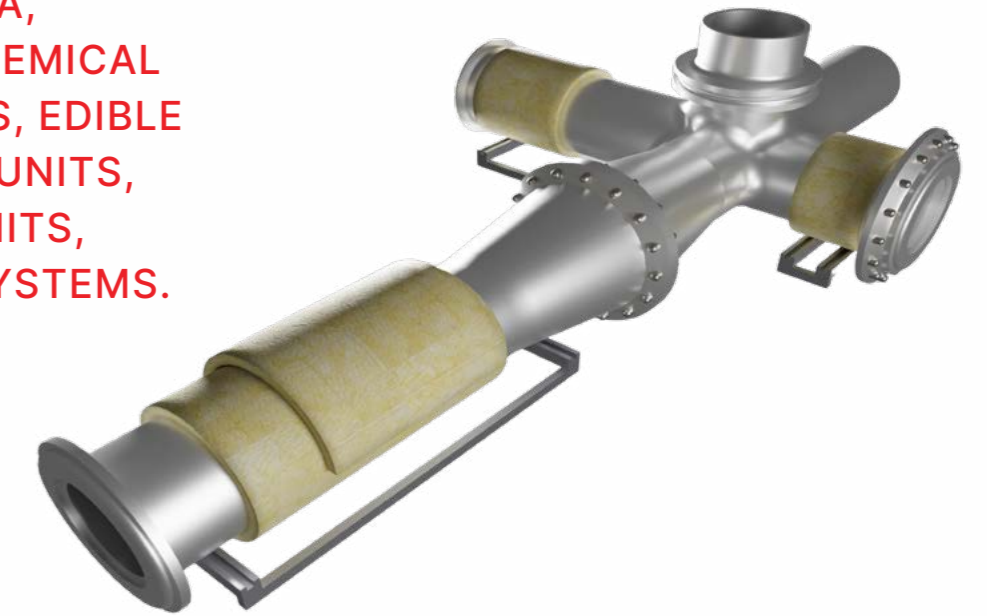

Pipe Section - 144 Kg/M³

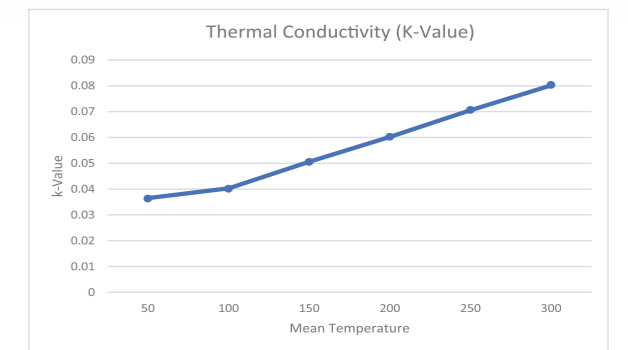

Product Specifications

Product Spec : IS: 9842, ASTM C-547, EIL:6-44-0002 REV 05

Service Temp : - 50°C to 750°C

Standard Length of Each Section : 1000 mm (1 Mtr)

Dimension : ½ inch to 16 inch (Nominal Bore)

Thickness : 25mm to 100mm

Density : 140 kg/M³ to 160 kg/M³

Packing : Corrugated Boxes

Facing : FSK & Unfaced

Application Field : Thermal Insulation of Piping & Personnel Protection

 **Pre-Formed Pipe Section**

 **Ease of Installation**

 **High Compressive Strength**

 **Rigid**

 **Less Joints and Wastage**

 **No Sagging**

Technical Parameters

Property	Value	Specification
Thermal Conductivity (W/mK)	Temperature 50 100 150 200 250 300 144 Kg/M ³ 0.0357 0.0371 0.0476 0.0618 0.0706 0.0817	IS:3346
Fire Resistant	Class 0	BS: 476
Maximum Service Temperature	-50°C to 750°C	IS:8183
Smoke Developed Index	0-25 (passes)	ASTM E-84
Flame Spread Index	0-25 (passes)	ASTM E-84
Linear Shrinkage	2% Max	EIL:6-44-0002 Rev. 05, ASTM C -356
Compressive Strength	8 kPa@10% Compression	EIL:6-44-0002 Rev. 05, ASTM C -165

Building a **Better Tomorrow** Through Innovation and Responsibility

Hi-Tec leads in innovation and responsibility with advanced stonewool insulation, redefining efficiency and safety standards. Our EnSave Advantage not only ensures environmental sustainability but actively reduces CO2 emissions, lowering carbon footprints and contributing to global temperature control. In industries like Oil and Gas, our insulation is pivotal, fostering operational efficiency and safety. Join us in building a better, eco-conscious tomorrow through our commitment to groundbreaking products.



Infrastructure and Machines

In an era where industry accounts for 37% of annual energy consumption and nearly 23% of energy-related CO2 emissions, Hi-Tec is a champion for transformative change. Our insulation products play a crucial role in enhancing efficiency, significantly reducing energy consumption and CO2 intensity.

Hi-Tec's commitment to sustainability extends across operations, incorporating the latest technology for efficient manufacturing process control, leading to lower fuel consumption and reduced carbon emissions. We prioritize sustainable sourcing of raw materials, ensuring a lower environmental footprint. Rigorous quality control measures are in place to guarantee our products meet specifications and adhere to the highest standards.

In a landscape of rising energy prices, our innovative insulation products act as catalysts for sustainable practices, safeguarding industry viability and the planet's well-being. By integrating cutting-edge technology, efficient processes, and a commitment to responsible resourcing, Hi-Tec pioneers a path toward a more sustainable and environmentally conscious industrial future.

EnSave Stone Wool Building Roll

EnSave Stone Wool Building Rolls are manufactured from melting Natural stones, spun to fine fibres with special binders with water-repellency properties. Ensave Building Rolls are factory laminated with variety of facings such as AI-FSK, BGT, ALG. It keeps the interiors of the work space thermally regulated & comfortable to work. Its most important feature is the fire resistance which provides safety from fire

EnSave Stonewool building rolls are light weight material. It has excellent water repellent properties, It is easy to install. EnSave Stonewool Building rolls are noise barriers, fire safe and keeps ambient temperature and with acoustic properties it makes inside surrounding comfortable to live, work & operate. Overall it enhances degree safety, efficiency and comfort.



PRE-ENGINEERED BUILDINGS, INDUSTRIAL SHEDS, WAREHOUSE, PRE-FAB HOUSES, AIRPORT HANGARS, COMMERCIAL & RESIDENTIAL ROOFS, WALLS, ETC.

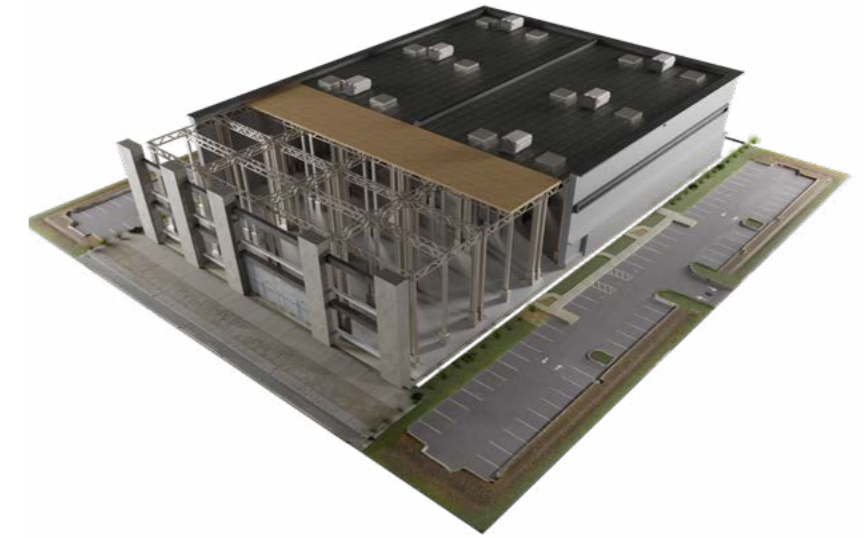

Building Roll - 48 Kg/M³

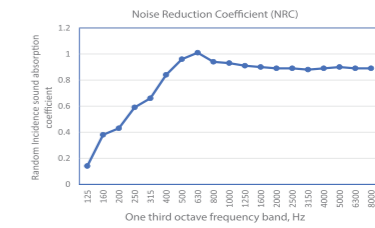
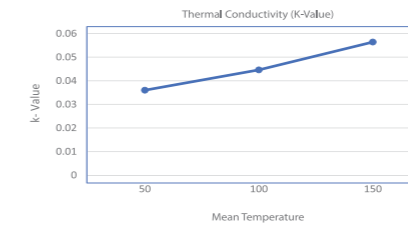

Building Roll - 64 Kg/M³

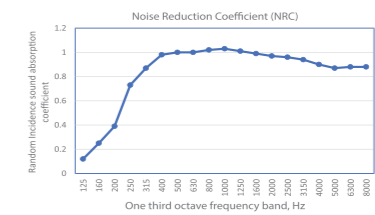
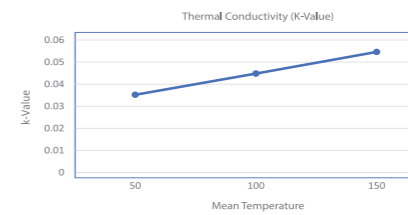

Product Specifications

Product Spec : IS: 8183, ASTM C-612, BS:3958 PART-5

Ambient Temp : 60°C

Size : Length – 5000mm to 10000mm, Width - 1100 mm

Thickness : 50 mm to 100 mm

Density : 48 kg/M³ to 64 kg/M³

Packing : LDPE Shrink Wrapped

Facing : FSK, ALG & UNFACED

Application Field : Thermal & Acoustic Insulation in Commercial & Residential Buildings Roofs, Walls & Duct Lines.



Flexible



Long Blanket



Long Resilient Blankets



Lightweight



Fewer Joints and Less Wastage

Technical Parameters

Property	Value						Specification
	Temperature	10	25	50	100	150	
Thermal Conductivity (W/mk)	48 Kg/M ³	0.0330	0.0340	0.0360	0.0446	0.0564	IS:3346
	64 Kg/M ³	0.0316	0.0332	0.0352	0.0448	0.0546	
R - Value	Temperature	10	25	50	100	150	IS:3346
	48 Kg/M ³	1.510	1.470	1.380	1.120	0.880	
	64 Kg/M ³	1.580	1.506	1.420	1.116	0.910	
Ambient Temperature	60°C						IS: 8183
Flame Spread Index	0-25 (passes)						ASTM E-84
Smoke Developed Index	0-25 (passes)						ASTM E-84
Noise Reduction Coefficient	0.90						IS: 8225
Fire Proof	Yes						BS:476 & ASTM E-84
Sound Proof	Yes						ASTM C423/ISO 354

Characteristics of Ensave Stonewool



Biologically inert

EnSave Stonewool stands as a testament to purity and safety, being biologically inert. Manufactured from volcanic rock through an extensive process, it ensures a non-reactive, stable environment. This characteristic not only ensures its safety in handling and installation but also aligns with the highest standards of health and environmental consciousness, making it a choice that prioritizes well-being and sustainability.

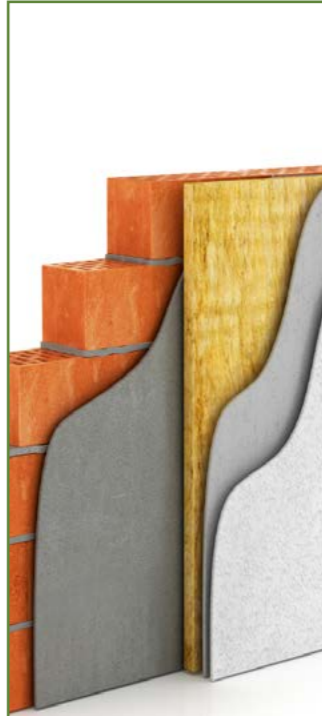

Compatible with building materials

EnSave Stonewool stands as the epitome of compatibility with building materials. Its versatility seamlessly integrates with diverse construction components. EnSave ensures harmonious synergy with various materials. This adaptability not only enhances installation convenience but also ensures the commitment to delivering insulation products that effortlessly complement and fortify safety and comfort of buildings and technical installations, as well as the living experience.



No health hazard

Ensuring a healthy environment, EnSave Stonewool boasts a no health hazard guarantee. Composed of natural volcanic rock fibers, our insulation products are non-combustible, asbestos-free, and emit no toxic fumes. Also, they are HFC and CFC-free, aligning with the latest safety regulations. This commitment extends from production to application, offering peace of mind to both installers and occupants, making EnSave the safe and sustainable choice for insulation needs.



Environment friendly

Embrace sustainability with EnSave Stonewool—a testament to our commitment to the environment. As a long-lasting and safe insulation material, it not only curtails energy consumption but also contributes to sound insulation and fire safety. Choosing EnSave Stonewool means opting for an eco-friendly solution that aligns with global efforts for a greener, safer, and more sustainable future. Moreover, by reducing energy consumption, EnSave aids in mitigating the impact of global warming, making it an integral part of the collective endeavor to combat climate change.

General properties

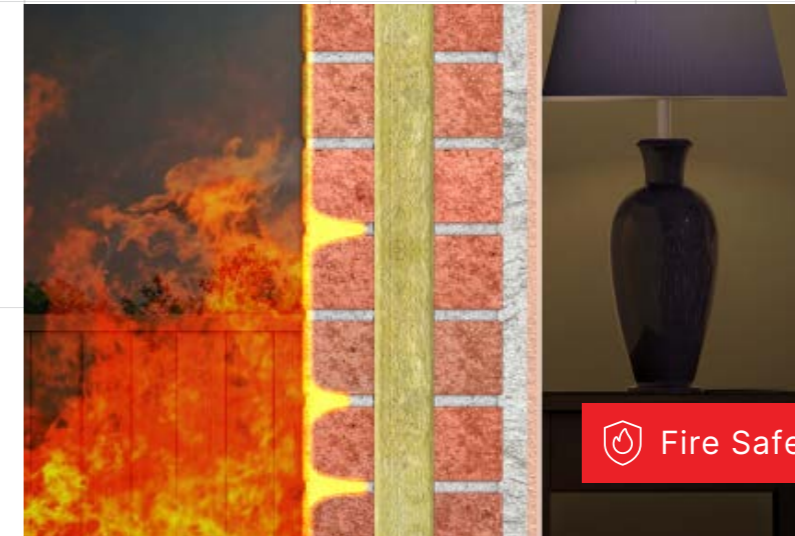

 Fire Safe



 Acoustic Regulation



 Thermal Stability

EnSave Stone Wool (Loose Wool)

EnSave Mineral Wool is an ideal material for most insulation applications because of its favourable handling and application characteristics. It is fire proof, dirt proof and moisture resistant. Ensave Loose Wool is durable, odourless, easy to handle. The properties of EnSave Loose wool include incombustibility, water replant, heat resistant, non corrosive, fire resistant, sound absorption etc. It is highly suitable for gap fillings, cavity packings, break liners and various other boards/tile making.

EnSave Stonewool in loose form comes without any resin/binder content, providing liberty to user for easy usage especially on areas where applying preformed stone wool application is difficult



**TURBINES, CAVITY FILLINGS,
INSULATION JOINT FILLINGS,
TILES & BOARDS**

Product Specifications

Product Spec : IS: 3677

Service Temp : 750°C Max

Packaging : HDPE Bags of 40Kg Each

Application Field : Thermal Insulation and Fillings in joints of insulation and for brake clutch pads.



**Unbonded Loose Stone
Wool Fibers**



**No Specific Density
or Thickness**



**In Fill Material For
Complex Shapes**

Technical Parameters

Property	Value						Specification
Thermal Conductivity (W/mK)	Temperature	50	100	150	200	250	IS:3346
	K- Value	0.041	0.049	0.058	0.072	0.085	
Maximum Service Temp.	750°C Max						ASTM C447
Flame Spread Index	0						ASTM E-84
Smoke Develop Index	0						ASTM E-84
Corrosion	Non-Corrosive						ASTM C-692
Water Absorption	Less than 1% by weight						ASTM C-1104



Applications of our thermal products

Explore the diverse domains where our thermal insulation products redefine efficiency, providing unparalleled products for a wide range of applications.

- 1 Mall
- 2 Pipes
- 3 Vessels
- 4 Chimney
- 5 Ducts
- 6 Warehouse
- 7 Metro Station
- 8 Airport
- 9 Building
- 10 Convention Centre
- 11 Theatre
- 12 Tanks
- 13 Columns
- 14 Seaport
- 15 Ship
- 16 Oil Rig

20

20 acre plant
At the heart of our operations producing high quality thermal insulation to meet the diverse needs of our customers

210000+

21000+ metric tonnes
We have an installed capacity of 21,000+ metric tonnes per annum.

5000+

500+ Satisfied customers

2011

Since 2011
With over a decade long experience in producing and delivering quality thermal solutions.

9001 & 45001

ISO 9001 & 45001 Certified
We are an ISO 9001 certified company, thus ensuring overall trust and compliance.

150+

150 crore+ group revenue, hi-tec rockfibre along with 2 sister corporations

19.8

19.8 million sqm in service and performing successfully

700000

70000 sq ft
Production plant spanning 70,000 sq.ft. to meet demands of growing industrial needs.

Client Approvals: A Testament to Success

Our success story is written in the approvals from our valued clients. We take pride in the trust bestowed upon us by a myriad of satisfied partners. Our dedication to excellence and commitment to delivering top-tier insulation products has garnered widespread acclaim. With each successful project, we not only meet but exceed client expectations, solidifying our reputation as a trusted industry leader. Join the ranks of those who have experienced the seamless quality and reliability of Hi-Tec, where client approvals illuminate the path to success.

EnSave Stonewool Fibre Insulation is manufactured with a stable composition to endure environmental challenges and handling. Our in-house laboratory, manned by knowledgeable experts and equipped with advanced instruments, guarantees compliance with top-notch domestic and international standards.

Hi-Tec Rock Fibre Pvt Ltd boasts an impressive 21,000 MTPA capacity, ensuring your projects match your scale. Centrally located for seamless accessibility, we prioritize swift deliveries to meet agreed timelines, establishing us as your dependable insulation partner.

Experience operational fluidity with our "Ease of Work" program, designed for smooth workflows and punctual deliveries. At Hi-Tec Rock Fibre Pvt Ltd, trust in a blend of capacity, convenience, and unwavering quality for your insulation needs.

